

Unpacking the box ..... 2  
 Installing the wireless module on the SonoSite Edge II or SonoSite M-Turbo stand ..... 3  
 Installing the wireless module on the SonoSite Edge II or SonoSite M-Turbo ..... 4  
 Installing the wireless module on the SonoSite X-Porte stand ..... 5  
 Removing the wireless module holder ..... 7

Use these instructions to install the Wireless and Security Module on the SonoSite Edge II, SonoSite M-Turbo, or the SonoSite X-Porte ultrasound system.

**Notes**

- ▶ You must remove any other wireless adapters before the system will use the Wireless and Security Module.
- ▶ This device is in compliance with the essential requirements and other relevant provisions of Directive 1999/5/EC, the FCC, and Industry Canada.

**Cautions**

- ▶ This device is restricted to *indoor* use when operated in the 5.15 to 5.25 GHz frequency range.
- ▶ Any changes or modifications not expressly approved by the party responsible for compliance could void the user's authority to operate this equipment. Operating the wireless USB adapter without a regulatory label or the correct country stamp is illegal. See the documentation from the manufacturer of the wireless USB adapter.
- ▶ Use only the cables that come in the kit to install the wireless USB adapter. Using other USB cables may negatively impact the performance of the adapter.

**WARNING**

To comply with FCC RF exposure compliance requirements, the antenna used for this transmitter must be installed to provide a separation distance of at least 20 cm from all persons and must not be co-located or operating in conjunction with any other antenna or transmitter.

# Unpacking the box

Wireless and Security Module (1)

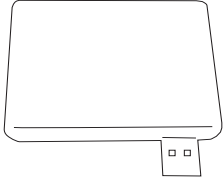

SonoSite Edge II, SonoSite M-Turbo, and SonoSite X-Porte wireless module holder mount, front (1)

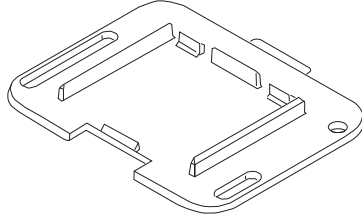

SonoSite Edge II and SonoSite X-Porte wireless module holder (1)

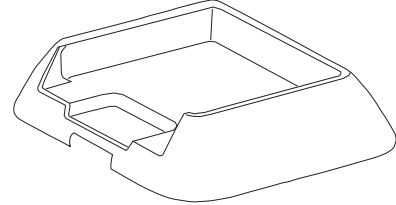

SonoSite Edge II template (1)

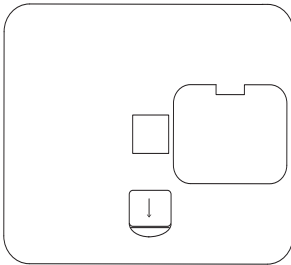

SonoSite M-Turbo template (1)

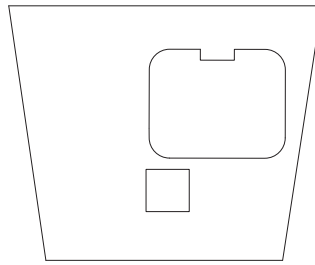

12 inch USB extension cord (1)

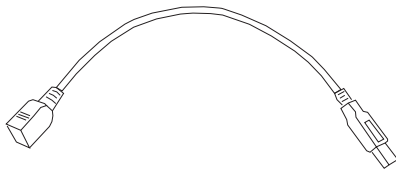

SonoSite Edge II 10 inch USB extension cord, right angle (1)

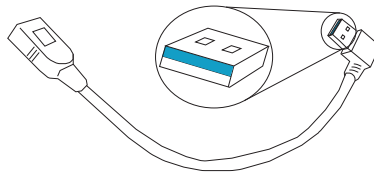

SonoSite M-Turbo 10 inch USB extension cord, left angle (1)

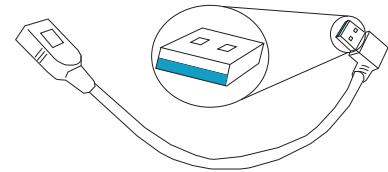

Isopropyl wipe 70% (1)

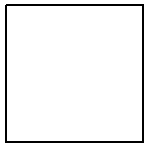

Allen wrench (1)

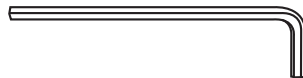

0.5 inch button head screws (3)

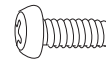

# Installing the wireless module on the SonoSite Edge II or SonoSite M-Turbo stand

**Note**

The following illustrations depict the SonoSite Edge II stand. You can use the same procedure to install the wireless module on the SonoSite M-Turbo stand.

## STEP 1

Press down the lever on two or more wheels.

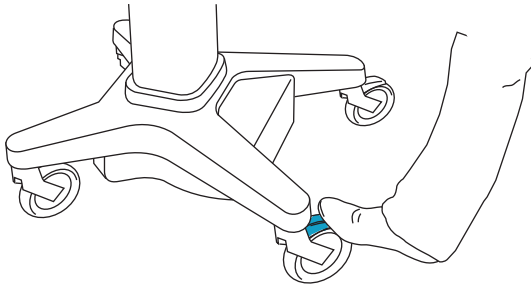

## STEP 2

Align the hole and slots on the wireless module holder mount to the holes located on the underside of the stand head. You do not need to remove the adhesive from the back of the mount.

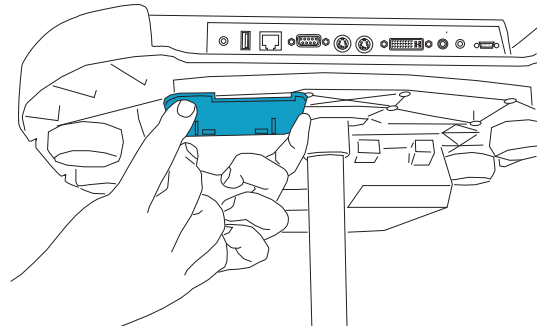

## STEP 3

Use the Allen wrench and screws to attach the mount to the stand head, starting with the back left hole.

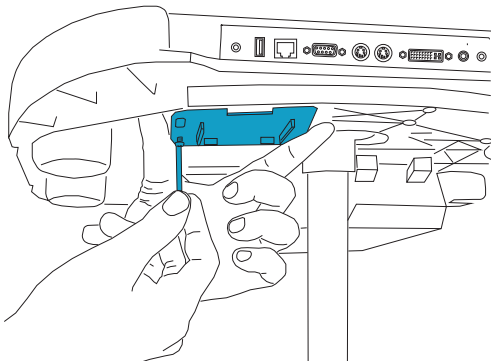

## STEP 4

Snap the wireless module holder into the mount.

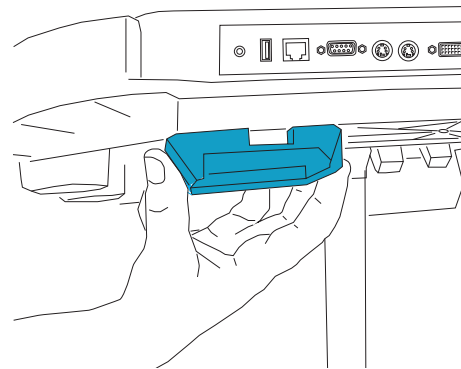

## STEP 5

Remove the USB cap, and snap the wireless module into the holder.

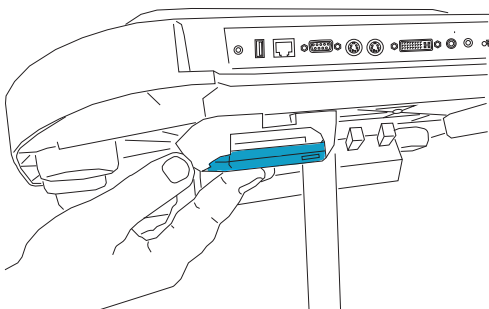

## STEP 6

Plug the wireless module into the system's mini-dock with the 12 inch USB cord.

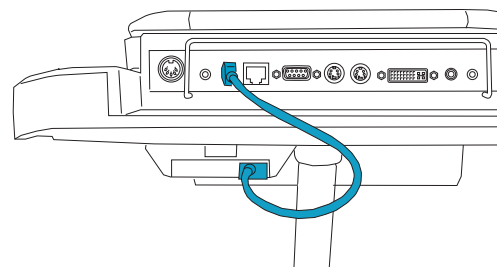

# Installing the wireless module on the SonoSite Edge II or SonoSite M-Turbo

**Note**

The following illustrations mostly depict the SonoSite Edge II. You can use the same procedure to install the wireless module on the SonoSite M-Turbo.

### STEP 1

Clean the system's lid with an isopropyl wipe.

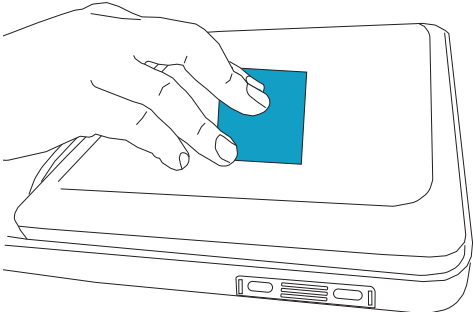

### STEP 2

Remove the backing and place the template on top of the system's lid.

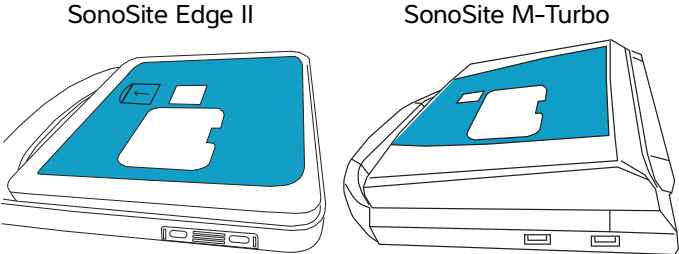

### STEP 3

Remove the adhesive from the back of the wireless module holder mount.

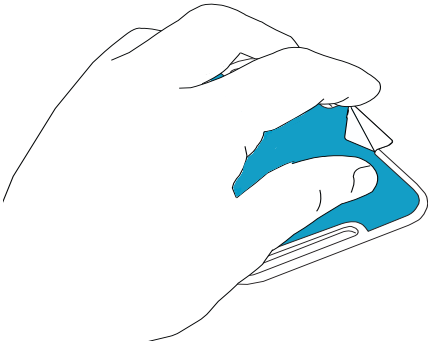

### STEP 4

Use the template to position and attach the mount to the system's lid.

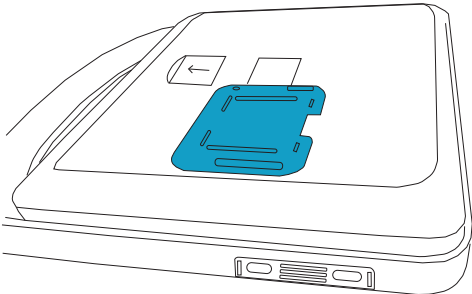

### STEP 5

Remove the template, and snap the wireless module holder into the mount.

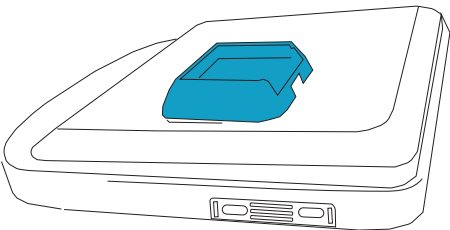

### STEP 6

Remove the USB cap, and snap the wireless module into the holder.

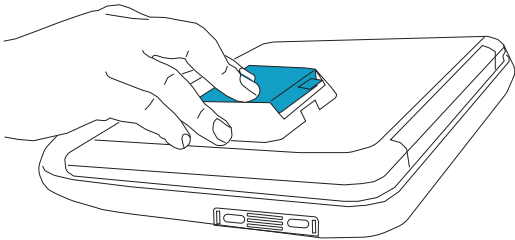

## STEP 7

Plug the wireless module into the system with the right-angled (SonoSite Edge II) or left-angled (SonoSite M-Turbo) USB cord.

### Caution

Be careful not to pinch the USB cord when opening and closing the system's lid.

SonoSite Edge II

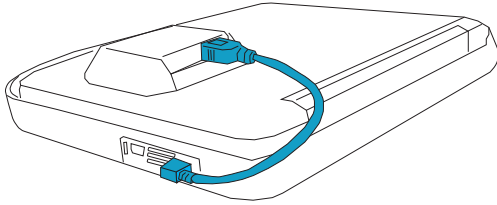

SonoSite M-Turbo

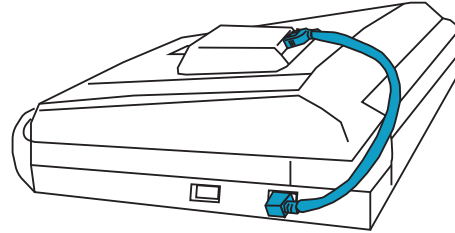

## Installing the wireless module on the SonoSite X-Porte stand

### STEP 1

Press down the lever on two or more wheels.

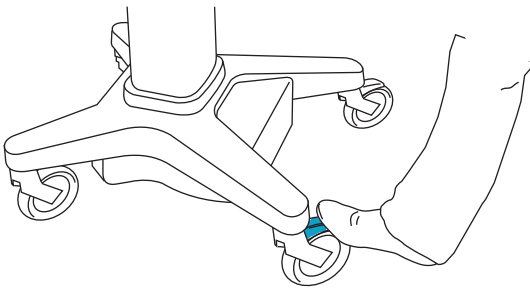

### STEP 2

Clean the right side of the column with an isopropyl wipe.

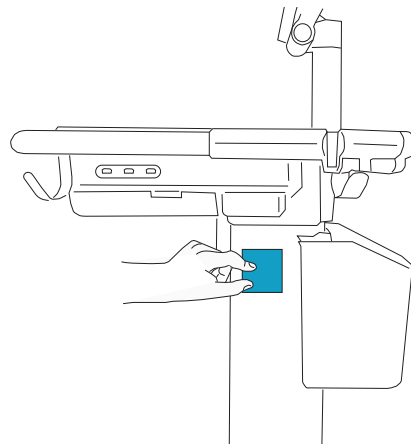

### STEP 3

Remove the adhesive from the back of the wireless module holder mount.

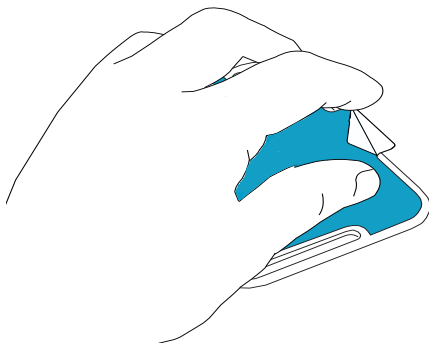

### STEP 4

Attach the mount to the side of the column, near the top.

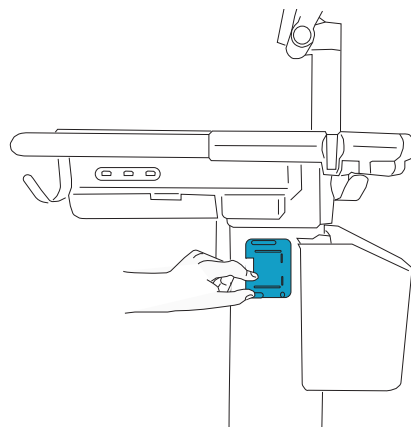

## STEP 5

Snap the wireless module holder into the mount.

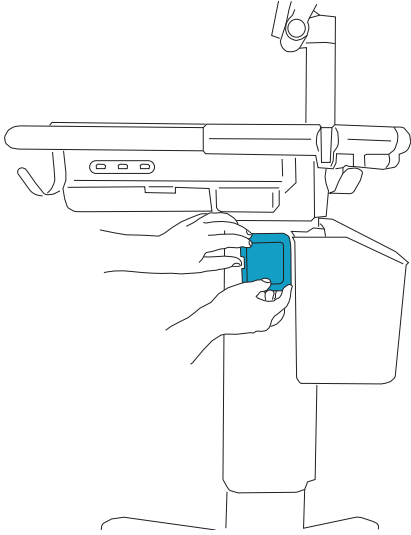

## STEP 6

Snap the wireless module into the holder making sure that the USB connector is at the top.

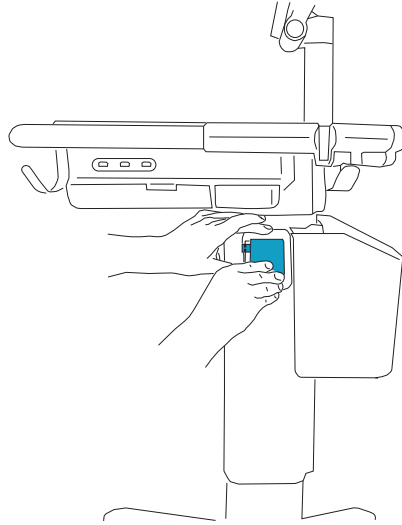

## STEP 7

Remove the USB cap, then plug the module into the system with the 12 inch USB cord.

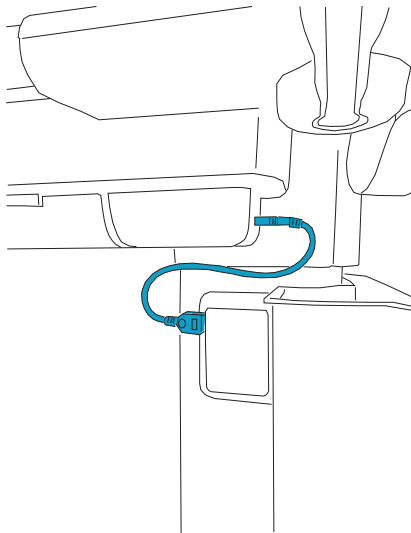

# Removing the wireless module holder

## STEP 1

Push on the back and pull up on the front of the wireless module holder at the same time, then pull it back to remove it completely.

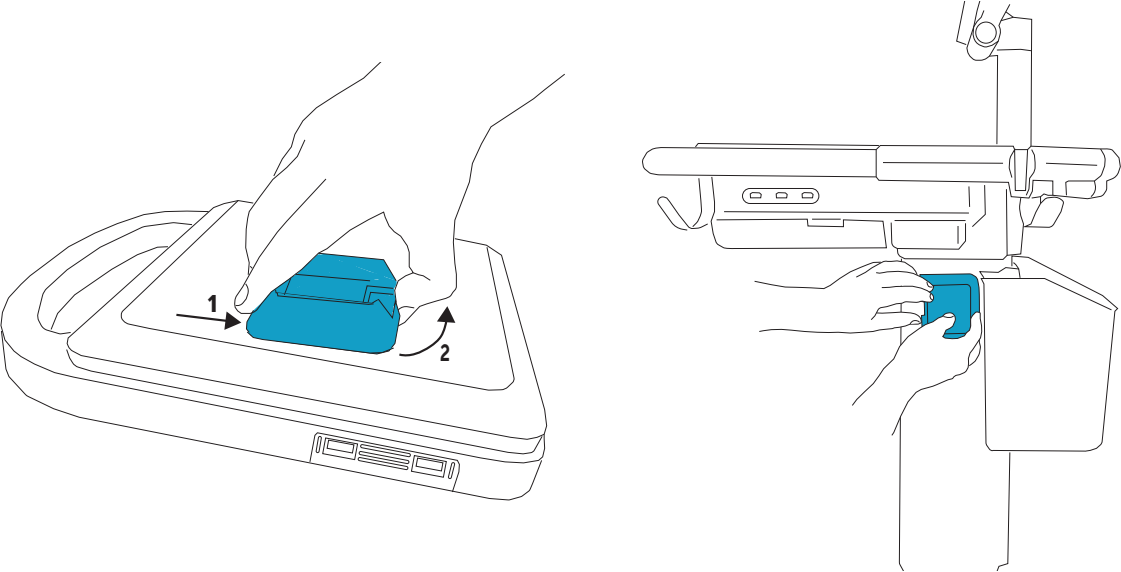

**Manufacturer**

FUJIFILM SonoSite, Inc.  
21919 30th Drive SE  
Bothell, WA 98021 USA  
T: 1-888-482-9449 or 1-  
425-951-1200  
F: 1-425-951-1201

**EC Authorized Representative**

FUJIFILM SonoSite B.V.  
Joop Geesinkweg 140  
1114 AB Amsterdam,  
The Netherlands

**Australia Sponsor**

FUJIFILM SonoSite  
Australasia Pty Ltd  
114 Old Pittwater Road  
BROOKVALE, NSW, 2100  
Australia



X-Porte, SonoSite Edge, SonoSite M-Turbo, and SONOSITE are trademarks or registered trademarks of FUJIFILM SonoSite, Inc. in various jurisdictions. FUJIFILM is a registered trademark of FUJIFILM Corporation. Value from Innovation is a trademark of FUJIFILM Holdings America Corporation.

All other trademarks are the property of their respective owners.

Published March 2020

Copyright © 2020 FUJIFILM SonoSite, Inc. All rights reserved.

P22132-03

